

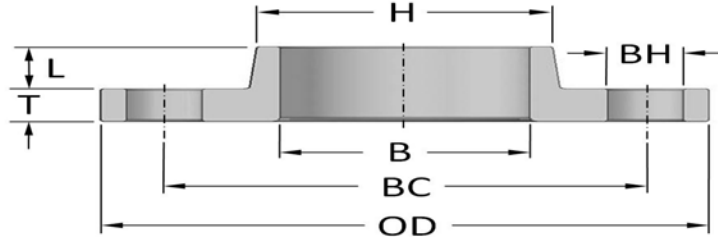

Forged Steel 150# Lap-Joint Flanges

ANSI 150# S/O Pattern*
 W/Lap-Joint Radius
 Primer-Painted and Hot-Dip Galvanized
 Dimensions in Inches



Nominal Size	Outside Diameter (OD)	Bore Diameter (B)	No. of Bolt Holes	Diameter Of Holes	Bolt Circle (BC)	Thickness (T)	Hub Length (L)	Hub Diam. (H)	Lap Radius (R)	Weight Each (lbs)
1	4.25	1.38	4	0.625	3.13	0.563	0.688	1.938	0.13	2
1 1/4	4.68	1.72	4	0.625	3.50	0.625	0.813	2.312	0.19	3
1 1/2	5.00	1.97	4	0.625	3.88	0.688	0.875	2.563	0.25	3
2	6.00	2.46	4	0.750	4.75	0.750	1.000	3.063	0.31	5
2 1/2	7.00	2.97	4	0.750	5.50	0.875	1.125	3.563	0.31	7
3	7.50	3.60	4	0.750	6.00	0.938	1.188	4.250	0.38	8
3 1/2	8.50	4.10	8	0.750	7.00	0.938	1.250	4.812	0.38	11
4	9.00	4.60	8	0.750	7.50	0.938	1.312	5.312	0.44	13
5	10.00	5.69	8	0.875	8.50	0.938	1.438	6.438	0.44	15
6	11.00	6.75	8	0.875	9.50	1.000	1.562	7.562	0.50	18
8	13.50	8.75	8	0.875	11.75	1.125	1.750	9.688	0.50	30
10	16.00	10.92	12	1.000	14.25	1.188	1.938	12.000	0.50	42
12	19.00	12.92	12	1.000	17.00	1.250	2.188	14.375	0.50	64
14	21.00	14.19	12	1.125	18.75	1.375	2.250	15.750	0.50	90
16	23.50	16.19	16	1.125	21.25	1.438	2.500	18.000	0.50	98
18	25.00	18.20	16	1.250	22.75	1.562	2.688	19.875	0.50	125
20	27.50	20.25	20	1.250	25.00	1.688	2.875	22.000	0.50	160
24	32.00	24.25	20	1.375	29.50	1.875	3.250	26.125	0.50	212
30**	38.75	30.25	28	1.375	36.00	2.125	3.500	32.750	0.50	305
36**	46.00	36.25	32	1.625	42.75	2.375	3.750	39.250	0.50	440

Bore Diameters listed above are stocked by CAB as standard. Larger or special bores are available on application.

* Hub lengths shown for 14" - 24" sizes are standard 150# S/O dimension. They do not conform to full ANSI B16.5 Hub Length dimensions which are available on application.

** 30/36" sizes listed are Class 125 (Full Weight) S/O pattern with Lap-Joint ID. Sizes larger than 24" are not covered by ANSI B16.5.